



自行车货架智能刹车尾灯 Bicycle Smart Brake Taillight for Rack

说明书 User Manual

W12BR-200



警告 WARNINGS 注意事项

- * 请在5℃至40℃的环境温度进行充电；
- * 充电时,建议使用5V USB电源适配器；
- * 充电完成后,请务必拔下充电接头；
- * 请勿在高温环境中进行充电、放电及存放,否则会加速电池老化；
- * 请勿将电池置于车内或接近热源处；
- * 正确充电后,若电池的使用时间越来越短,则表示电池已达到有效使用寿命,请在当地维修点更换电池,并遵照当地法规,妥善处理废弃电池。

存放注意事项:

- * 本产品在不使用的情况下,每隔3个月需要充电一次,以免造成电池损坏,导致无法使用；
- * 请将车灯充满电后存放于阴凉干燥处。

使用注意事项:

- * 请勿将产品丢入火里；
- * 请勿将产品浸泡在水里；

ATTENTION:

- * Please charge the product at the environmental temperature between 5°C and 40°C.
- * When charging, it is recommended to use a 5V USB power adapter.
- * After charging, please unplug the power connector.
- * Please do not charge, discharge or store the product in high temperature environment, otherwise it will accelerate the battery aging.
- * Please do not put the battery in car or near power sources.
- * After correct charging, if the battery life is getting shorter and shorter, it means that the rechargeable battery has reached its effective service life. Please replace the battery at the local maintenance point and properly dispose of the used rechargeable battery according to local regulations.

STORAGE PRECAUTIONS:

- * The product needs to be recharged every three months without being used, so as to avoid battery damage and unusable situations.
- * Please fully charge the lights and store them in a cool dry place.

USING PRECAUTIONS:

- * Please do not throw the product into fire.
- * Please do not soak the product in water.

一、包装清单 PACKAGE LIST

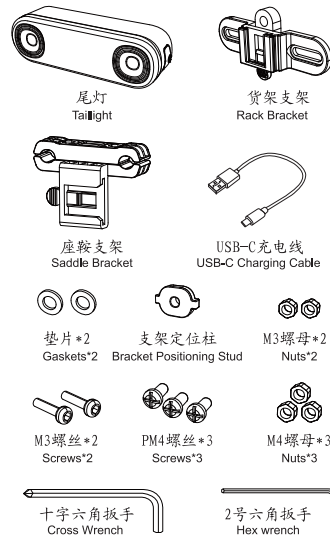

二、横向螺丝孔货架安装装配示意图 RACK MOUNTING OPTION 1

取出货架支架先将垫片套进螺丝,对准货架螺丝孔位,并在后方用螺母拧紧即可。(横向螺丝孔安装孔距: 41mm ≤ X < 73mm)

Take out the rack bracket, and put the gaskets into the screws first. Align the screw holes of the rack, then tighten with nuts on the back side. (The Screw Hole Mounting Size: 41mm ≤ X < 73mm)

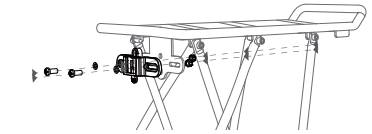

再把W12BR尾灯从上下插入货架支架,听到“咔”的一声安装完成。

Insert the W12BR taillight into the rack bracket from top to bottom, until you hear a "click" sound. The installation is complete.

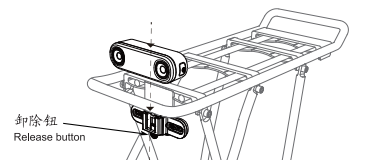

注意: 按压解除钮并向上抽出才能取下尾灯。
Note: Press the release button and pull it up to remove the taillight

三、竖向螺丝孔货架安装装配示意图 RACK MOUNTING OPTION 2

请先在货架支架后方安装支架定位柱,再将垫片套进螺丝,并对准货架螺丝孔位,在后方用螺母拧紧即可。(竖向螺丝孔安装孔距: 19mm)

Mount the rack bracket positioning stud on the back of the bracket, then put the gaskets into the screws. Align the screw holes of the rack, then tighten with nuts on the back side. (The Screw Hole Mounting Size: 19mm)

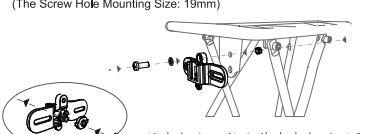

将支架定位柱安装在支架的后部
Mount the positioning stud at the back of the bracket

再把W12BR尾灯从上下插入货架支架,听到“咔”的一声安装完成。

Insert the W12BR taillight into the rack bracket from top to bottom, until you hear a "click" sound. The installation is complete.

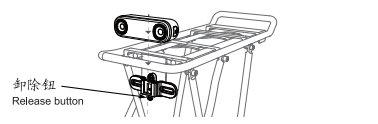

注意: 按压解除钮并向上抽出才能取下尾灯。
Note: Press the release button and pull it up to remove the taillight

四、座鞍支架安装装配示意图 SADDLE BRACKET MOUNTING

请先将座鞍支架如图所示安装在座鞍上,放好螺母,并对准螺丝孔位,再用2号扳手拧紧即可。

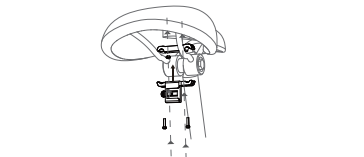

再把W12BR尾灯从右往左插入座鞍支架,听到“咔”的一声安装完成。

Insert the W12BR taillight from right to left into the saddle bracket until you hear a "click" sound. The installation is complete.

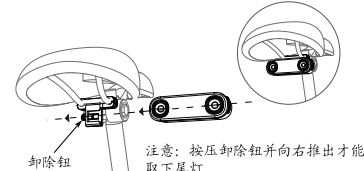

注意: 按压解除钮并向右推出才能取下尾灯。
Note: Press the release button and pull it from the right side to remove the light

保修凭证 Warranty Certificate

用户资料 (顾客填写)
User's Information (Filled in by User)

姓名: _____ 联系电话: _____
Name: _____ Phone: _____

邮编: _____
Zip Code: _____

地址: _____
Address: _____

购买日期: _____年____月____日
Purchase Date: _____ Year _____ Month _____ Day

以下由售货员填写:
The following are filled in by the consignee:

销售资料:
Sales Information:

销售单位 (加盖公章):
Sales Company (Stamped with Company Seal):

联系电话: _____
Phone: _____

地址: _____
Address: _____

就近服务指导 (顾客第一时间的联系点)
Nearby Service Guidance (Customer First Contact Point)

服务单位名称:
Service Unit: _____

联系电话: _____
Phone: _____

地址: _____
Address: _____

保修卡

五、档位模式及开关按键 WORKING MODES AND POWER BUTTON

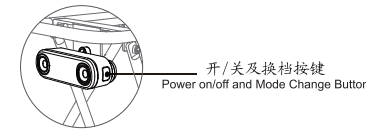

开/关及换档按键
Power on/off and Mode Change Button

长按电源按键0.75秒开/关机。
单击换档: 依次顺序为(省电模式-林道模式-雾灯模式-低常亮5lm-高常亮15lm-循环)

Long press the power button for 0.75 second to turn on/off the light; Short press the power button to change the modes; (Power Saving Mode - Trail Mode - Fog Light Mode - Low Steady 5lm - High Steady 15lm - Cycle)

刹车功能: 尾灯开机后,通过传感器智能感应刹车,当感应到刹车时,表现为60流明常亮3秒;无刹车感应时,则跳回原档位。

Brake Function: After power on, when brake status is detected in any mode, the light goes into 60lm high brightness for 3 seconds. If no brake status is detected, it goes back to the previous working mode.

开/关刹车功能: 开机状态下的任意档位,长按3秒,主灯闪烁三次后松手,恢复原档位并开/关刹车功能。
Brake Function On/Off: In any working mode when the power is on, press and hold the power button for 3 seconds until the light flashes three times, and then release it. The light will return to the original working mode, and brake function will be turned on/off.

七、充电 CHARGING

睡眠模式: 开机状态下尾灯静止120秒后,自动进入休眠状态,表现为熄灯。感受到震动或者短按按键时返回休眠时所在档位。

Sleeping Mode: After power on, the light will go off and enter sleeping mode if no motion is detected after 120 seconds. When motion is detected, or press the power button, the light will go back to the previous working mode.



六、档位及工作时长 WORKING MODE & RUNNING TIME

模式 Working Mode	流明 Lumens	时间 Running Time
省电模式: 低亮慢闪 Power Saving Mode: Low Slow Flash	5lm	≈150 hrs
林道模式: 高亮快闪 Trail Mode: High Quick Flash	15lm	≈62 hrs
雾灯模式: 高亮变频闪 Fog Light Mode: High Frequency Flash	200lm	≈10 hrs
低常亮 Low Steady	5lm	≈45 hrs
高常亮 High Steady	15lm	≈18 hrs

八、反光器 REFLECTOR

当尾灯处于关机状态时,在被车灯照射则会反光,警示机动车注意前方。

When the taillight is off, the light will be reflected when it is irradiated by the light from other road users to warn motor vehicles to pay attention.

当电池电量低于20%,红色电量指示灯闪烁。电量过低致关机后,长按按键不能开机,但红色电量指示灯闪烁三秒。

When the remaining power is below 20%, the red indicator light flashes. If the light is turned off due to low battery, the light can not be turned on by long press the power button, and the red indicator light will flash for 3 times.

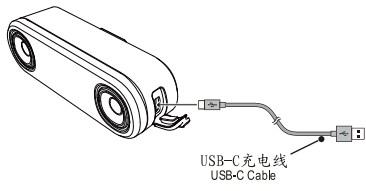

USB-C充电线
USB-C Cable

九、技术参数 SPECIFICATION

产品型号 Model	W12BR-200
灯珠 Light Source	LED
最高亮度 Max Brightness	200lm
电池容量 Battery	1200mAh
输入 Input	5V/1.0A
标准充电时间 Charging Time	≈1.5hrs
反光器 Reflector	0°大回復反光器 0° large recovery reflector
可视角度 Visual Angle	> 300°
发现距离 Vehicle Found Distance	> 1000m
防水等级 Waterproof	IPX6
产品尺寸 Dimension	100*31*32mm
产品净重 Net Weight	≈73g



深圳市加雪龙科技有限公司
Shenzhen Gaciron Technology Co., Ltd

公司地址: 广东省深圳市宝安区28区大宝路49号众创创新社区一层101
Headquarters: Rm101, Jinyin Hub, Innovation Community, Honggang North, No. 49th, Dabao Rd, 28th District, Bao'an, Shenzhen, China

全国统一售后服务热线: 86 755 23322700
Customer Service Hotline:

网址: www.gaciron.com
Website:

产品执行标准: QJXL 002-2022
Product Standard:

产地: 中国东莞
Made in China

