

专业自行车前灯 Professional Bicycle Headlight

产品说明书 User Manual

V9DP-2000

警告 WARNING 注意事项

- *请在5℃至40℃的环境温度进行充电；
- *充电前请检查充电线是否良好；
- *充电时，请使用5V USB电源适配器；
- *充满电后，请务必拔下充电接头；
- *请勿在高温环境里进行充电、放电及存放，否则会加速电池老化；
- *请将车灯充满电后放置在阴凉干燥的环境下存放，勿将车灯置于车内或接近热源处；
- *正确充电后，若电池的使用时间越来越短，则表示充电电池已达到有效使用寿命，请在当地维修点更换电池，并遵照当地法规，妥善处理废弃充电电池。
- *本产品在不使用的情况下，每隔3个月需要充电一次，以免造成电池损坏，导致无法使用；
- *灯头请勿对着眼睛开机；
- *长时间使用车灯时，请勿触摸车灯以免烫伤；
- *在没有成年人监护的情况下请勿给儿童使用。

- *Please charge the product at the environmental temperature from 5 to 40 degrees Celsius;
- *Please check whether the charging cable is good before charging;
- *When charging, please use the 5V USB power adapter;
- *Please pull the charging plug out after charging;
- *Please do not charge, discharge or store in the hot environment, otherwise it will accelerate the aging of the battery. Please store the fully charged headlights in a cool and dry place;
- *After the correct charge, if the battery usage time is shorter and shorter, it means that the rechargeable battery has reached the effective service life. Please replace the battery at the local maintenance point and properly dispose of the waste rechargeable battery according to local regulations;
- * This product should be charged once every 3 months without use, so as not to cause damage to the battery and resulting in unusable condition;
- *Please do not stare at the light when it is just turned on to avoid damaging the eyesight.
- *After the light is used for long time, please do not touch the light to avoid getting scald.
- * Children are forbidden to use without adults' supervision.

一、产品介绍 PRODUCT INTRODUCTION

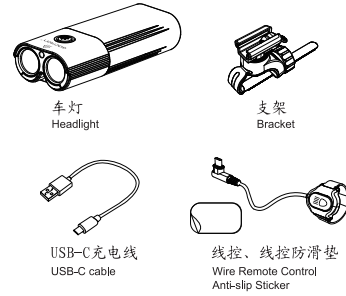

二、产品安装 INSTALLATION

1. 将支架的固定带展开并绑在车把上，拧紧支架螺母，支架安装完成。
Mount the bracket to the handlebar as below picture, and tighten the nut.

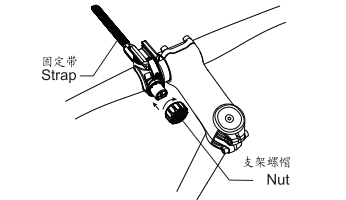

2. 将车灯底部滑入支架上，听到“咔”的一声，安装完成，并调整好车灯照射角度。
Slide the bottom of the light into the bracket. When you hear a "click" sound, the installation is complete. Please adjust the light angle.

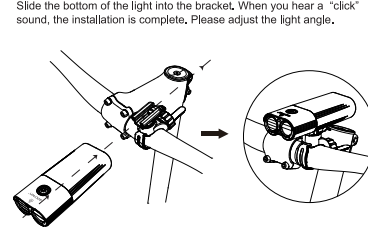

1. 车灯照射角度调整

先将支架螺母拧松，调整好车灯照射角度后锁紧支架螺母。车灯可根据实际使用需要左右调整角度，支架可调角度为360°。
请注意：调整车灯照射角度时应避免直射对向驾驶员与行人的眼睛。

2. Light Angle Adjustment

Loosen the nut slightly to move the bracket and then tighten the nut firmly to fix the bracket after adjusting the light angle. Adjust the light with the 360°adjustable bracket to meet your actual need.
Attention: Adjust the light angle so it does not hit directly into the oncoming traffic.

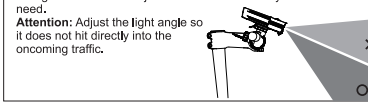

三、线控安装 INSTALLATION OF THE REMOTE CONTROL

将线控防滑垫贴于线控开关背面，揭开车灯底部胶塞将线控插入。在确保安装到位后将线控按键一端绑在车把上，调整至合适位置。
(线控与机身按键功能一致)

Paste the anti-slip sticker on the back of the switch of the wire remote control. Open the rubber plug cover on the bottom side of the light, insert the Type-C end of the remote control into the light in place. Tie the remote control firmly to the handlebar on appropriate position.
(The function of the wire remote is the same with the power button of the light)

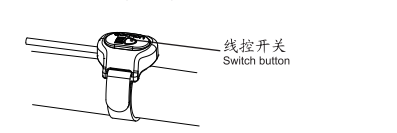
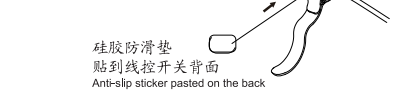
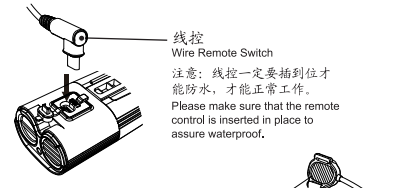

保修凭证 Warranty Certificate

用户资料 (顾客填写)
User's Information (Filled in by User)
姓名: _____ 联系电话: _____
Name: _____ Phone: _____

邮编: _____
Zip Code: _____
地址: _____
Address: _____

购买日期: _____年____月____日
Purchase Date: _____ Year _____ Month _____ Day

以下由售货员填写:
The following are filled in by the consignee:

销售资料:
Sales Information:
销售单位名称 (加盖公章):
Sales Company (Stamped with Company Seal):

联系电话: _____
Phone: _____
地址: _____
Address: _____

就近服务指导 (顾客第一时间的联系点)
Nearby Service Guidance (Customer First Contact Point)

服务单位名称: _____
Service Unit:
联系电话: _____
Phone: _____
地址: _____
Address: _____

保修卡

1. 有关售后服务事宜，请与经销商联系，正常使用出现质量问题，自购机之日起七天内包退，十五天内可免费更换本公司同一型号的产品，但产品包装不可以使用。
2. 购买时间以经销商开出的发票或收据为准。
3. 在下列情况下包换、保修失效，但提供有偿的维修服务。
(1) 一切人为因素损坏，如非正常工作环境下使用，不按说明书使用引起的损坏等；
(2) 客户自行修改改装，或未经本公司授权的单位维修；
(3) 购买后因运输不良造成的损坏；
(4) 本公司产品保修单包括/保修，需服务时，请提供购机发票或收据。
4. 下述一切非正常使用情况下造成的任何损失，本公司将不承担任何责任。
(1) 因用户错误使用造成安全隐患或意外事故；
(2) 因不可抗力因素造成的安全隐患或事故；
(3) 消费者未按照说明书规定进行操作，使用非说明书上要求的配件等消耗材料造成对第三方配件的损坏及意外事故或人身伤害。
6. 无论您在何处购买本产品，均可在最近的售后服务点得到同样完善的服务。如问题没有得到妥善解决，请致电或来函客户服务部。
7. 对以上条款的修改及解释权归本公司所有。

Warranty Card

1. Please contact the wholesaler for customer service. For inherent problems under correct use, we accept a return during seven days since purchase. Users are allowed to replace a new product of the same model for free within fifteen days since purchase, and package is excluded in the replacement.
2. Purchase date is defined in accordance with the invoice or receipt made by wholesaler.
3. Under the following circumstances, replacement and warranty are both invalidated, but we offer a paid repair service.
(1) All damages caused by subjective factors, such as using under abnormal conditions or against the user manual.
(2) User's independent repairing and modifying or other unauthorized maintenance.
4. Hidden safety hazards or accidents caused by irresistible factors.
5. Damages or accidents or injuries caused by user's independent operation against the manual or using other materials or accessories on the product which causes malfunction.
6. Wherever you purchase this product, you have the total access to equivalent services from the nearest customer service center, if the problem is not solved to your satisfaction, please make a phone call to us or email to our customer service department.
7. The company reserves all the right to modify and explain the above terms.

四、输出 OUTPUT

揭开USB胶塞，插入USB充电线，可以给需要充电的设备充电(5V) 如：手机、平板、尾灯、相机等。
注意：USB数据线一定要插到位，才能给其他设备充电。
Unplug the USB rubber plug, insert the USB cable into the port to charge the device which is needed, such as mobile phone, tablet, taillight, camera, etc.
Note: The USB cable must be plugged into place before charging other devices.

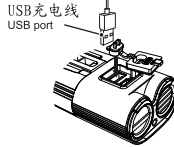

五、输入 INPUT

揭开车灯底部胶塞，将USB-C充电线插入后连接充电设备，按键电量指示灯显示红色闪烁，即开始充电，充满后电量指示灯变为蓝色。
Open the rubber plug cover on the bottom side of the light, insert the Type-C cable into the light Type-C port and connect the cable to charge the unit. When the red light is flashing, the light is charging. When the blue light is on, charging is complete.

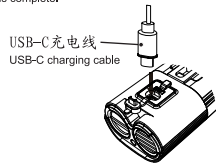

六、操作说明及功能介绍 OPERATION AND FUNCTION



模式 Working Mode	时间 Running Time
极亮档/Ultra High Steady 2000 lm	≈2 hrs
高亮档/High Steady 1000 lm	≈4 hrs 20 mins
中亮档/Medium Steady 500 lm	≈6 hrs 10 mins
低亮档/Low Steady 250 lm	≈12 hrs 10 mins
呼吸闪/Breathe 100-50 lm	≈37 hrs
爆闪/Strobe 1000 lm	≈5 hrs 30 mins

1. 开关机：长按电源按键0.75秒。
切换档位：短按电源按键(依次为：极亮2000 lm一呼吸闪-低亮250 lm-中亮500 lm-高亮1000 lm-循环)。
爆闪：长按电源按键2秒进入爆闪模式1000 lm，单击回到原档位。

Turn ON/OFF: Long press the power button for 0.75 seconds.
Switch modes: Short press the power button (Ultra High 2000 lm - Breathe - Low 250 lm - Medium 500 lm - High 1000 lm - cycle).
Strobe mode: Long press the power button for 2 seconds to enter strobe mode 1000 lm, single click to exit.

2. 带记忆档位功能：开机时，默认恢复上一次关机时的档位。

With Memory Mode Function: When you turn the light on, it lights up in the last lighting mode you used.

3. 锁定功能：任何情况下长按超过7秒，会强制关机进入锁定模式；锁定模式中无法正常开机，点击电源按键会提示当前电量5秒后熄灭指示灯，锁定后长按7秒，解锁恢复正常，锁定模式中不影响移动电源功能。

Lockout Function: To enter the Lockout mode, press and hold the power button over 7 seconds, the light will be off and locked out. In lockout mode, light cannot be on normally. Click the power button, then the indicator light will be on for 5 seconds before it is off. To exit the lockout mode, long press for 7 seconds. The light will power on and operate normally. The power bank function is not affected in the lockout mode.

剩余电量 Remaining Battery	颜色显示 Indicator Color
100-41%	蓝色/Blue
40-21%	黄色/Yellow
20-1%	红光闪烁/Red Flash
充电时长约4小时/Charging Time: ≈4 hours	

电路保护：
过充保护/高温保护/过放保护/短路保护

温控降档：监测内部元器件75℃(温度高于75℃自动降回中亮档，自动监测到65℃跳回原档位)。
监测内部元器件85℃高温保护会自动关机。

Circuit Protection: Circuit overcharge protection, high temperature protection, overdischarge protection, short circuit protection. If the light gets hot and the inner component temperature of 75℃ is detected, it switches to medium brightness mode. When temperature is cooled off to 65℃, it switches back to original brightness mode. The light turns off automatically when internal component temperature of 85℃ is detected.

温控元器件异常保护：
智能检测NTC正常工作5秒后会自动关机。

Temperature Control Components Protection:
The light will automatically power off after 5s if detecting the NTC malfunction intelligently.

七、技术参数 SPECIFICATION

产品类型 Model	V9DP-2000
灯珠 Light Source	LED*2
最高亮度 Max Brightness	2000 lm
电池容量 Battery	2*18650 3350mAh
输入 Input	5V/2.0A
输出 Output	5V/2.0A
标准充电时间 Charging Time	≈ 4h
泛光角度 Floodlight Angle	> 125°
照射距离 Beam Distance	> 200m
防水等级 Waterproof	IPX6
产品尺寸 Dimension	118*52*32mm
产品净重 Net Weight	≈ 203g



深圳市加雪龙科技有限公司
Shenzhen Gaciron Technology Co., Ltd

公司地址：广东省深圳市宝安区28区大宝路49号众创新社区一层101
Headquarters: Rm101, Joinin Hub, Innovation Community, Hongliang North, No. 49th, Dabao Rd, 28th District, Bao'an, Shenzhen, China

全国统一售后服务热线：86 755 23322700
Customer Service Hotline:

网站：www.gaciron.com
Website:

产品执行标准：Q/JXL 004-2022
Product Standard:

产地：中国 东莞
Made in China

RoHS

CE

CE

RoHS

RoHS

