

# Operation Instructions

## interface definition:



① Reset key ② Power indicator light ③ Type-C interface

## Connection instructions:

- 1 . Use the data cable to connect the box with the "Type-C" or "USB" port of the vehicle. (The power light is blinking)
- 2 . Open iPhone - Settings - [Wi-Fi] (Wireless LAN), as shown below:



3 . Open iPhone - Settings - [Bluetooth], as shown below:



4 . Open iPhone - Settings - [Personal Hotspot], as shown below:



5 . Open iPhone again - Settings - Bluetooth - Search box name: SmartBox -... Click [Pair], as shown below:

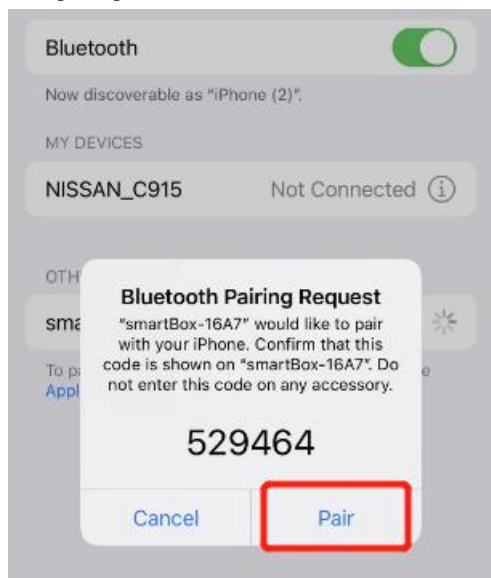

- 6 . iPhone prompt: Allow synchronization of "address book" Select Allow, as shown in the following image .

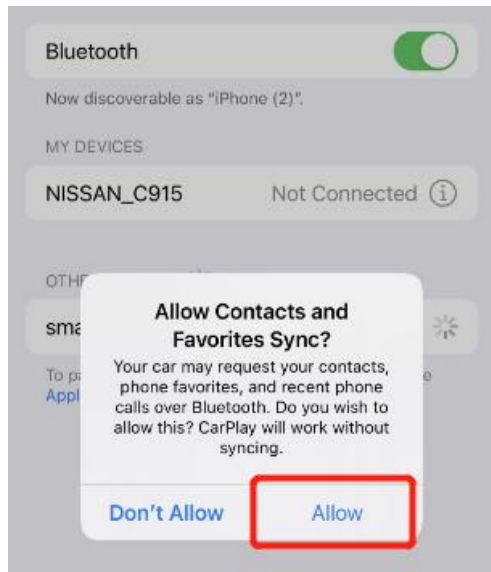

- 7 . After the iPhone prompts that the Bluetooth box is successfully connected, wait for a few seconds...the iPhone will prompt: Use Carplay with " Smartbox.. " select [Use CarPlay], as shown in the figure below: (Note: some mobile phones may not prompt)



- 8 . Open the central control screen of the car, click the [4G] icon in the upper right corner of the screen, as shown in the figure below:

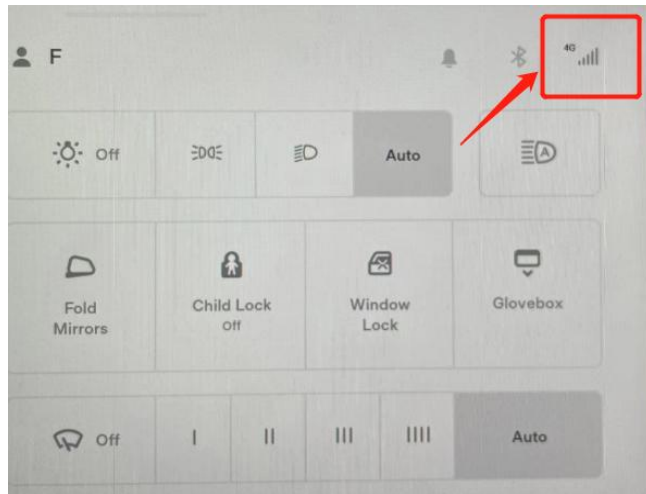

- 9 . Click to connect and prompt to enter the password: the password is 88888888, as shown in the figure:

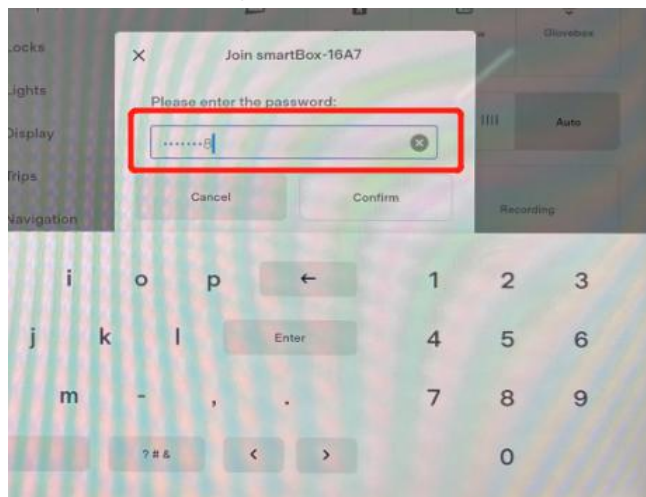

- 10 . The central control screen of the car shows that the network hotspot of the box is successfully connected (showing a small green tick), as shown in the figure below:

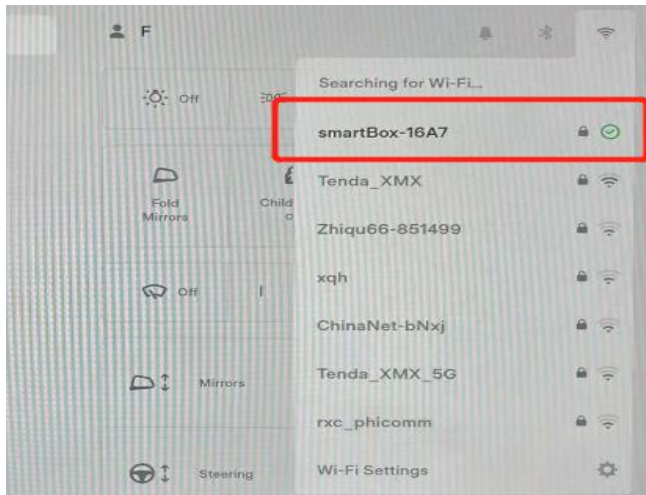

11 . Open the menu column under the central control screen of the vehicle -- select: [Browser] icon, as shown in the following figure.



12 . After entering the browser, enter the IP address: tslbox.cn and click [Enter] on the keyboard, as shown in the following figure:

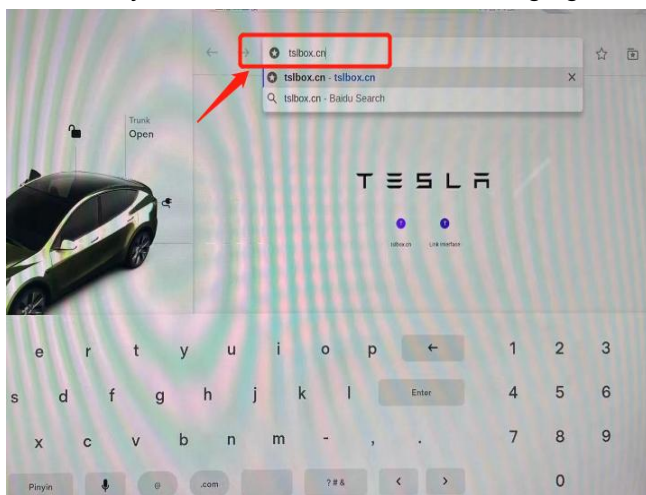

13. After waiting for a few seconds, the CarPlay UI will be displayed on the car computer screen, as shown in the following figure:

[Note: This step is to finish the display of Carplay on the screen, and the next step will finish the voice connection.]

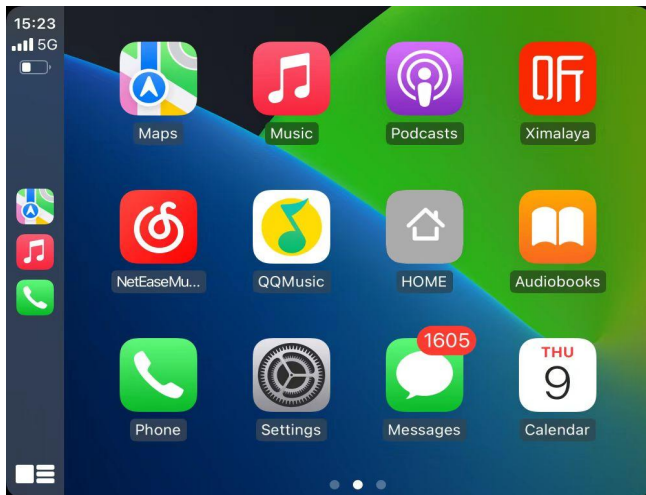

14. Open the menu column under the central control screen of vehicle and machine -- select the [Bluetooth] icon to open the vehicle and machine Bluetooth interface, As shown in the figure below:

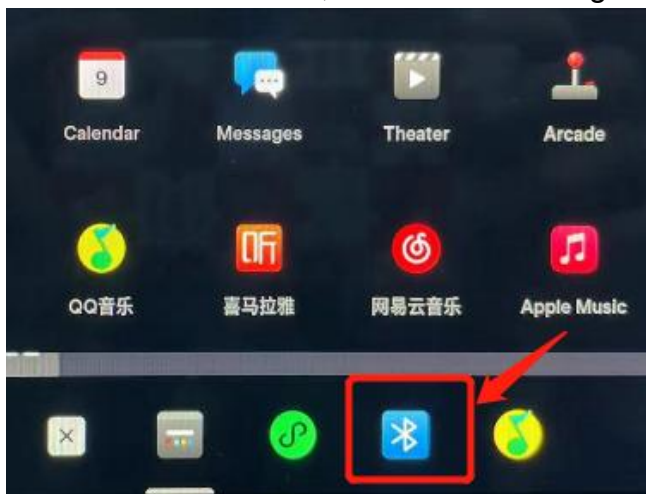

15 . On the Bluetooth interface, click: [Connect phone+], as shown below:

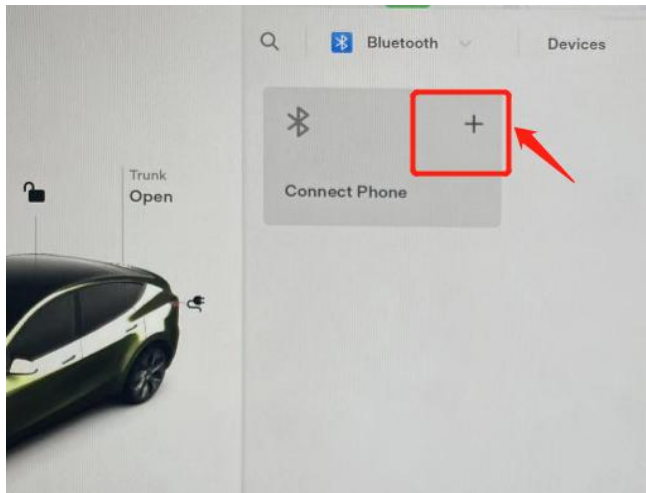

16 . Click Start Search, as shown in the following figure:

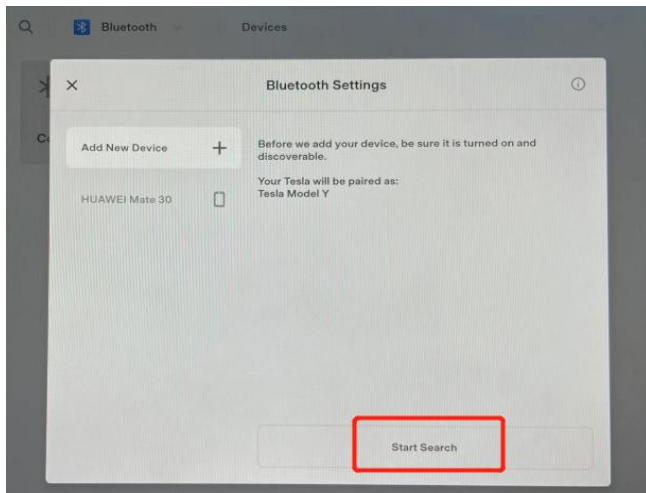

17 . Select your iPhone Bluetooth name (e.g. iPhone 2), as shown below

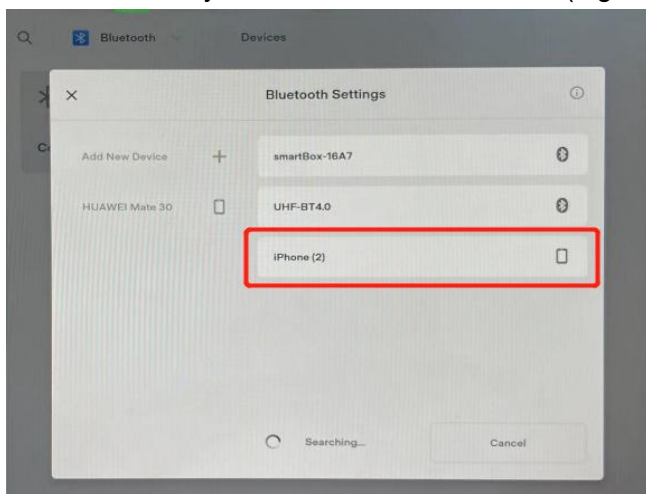

18. When central control screen of the vehicle prompts “confirm that the number is displayed on your mobile device”, Your iPhone also prompts: Bluetooth pairing request, click [pairing] to connect, as shown in the following figure

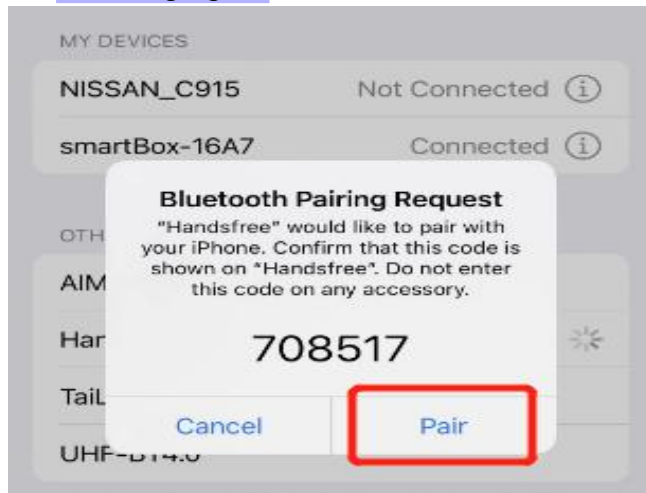

19. Complete the Bluetooth connection between the iPhone and the central control screen of the vehicle and display the “Connected” status, as shown in the following figure:



- 20 . In order to ensure that CarPlay function can be used during driving, it is necessary to turn on [Keep connecting during driving], and click the WiFi settings of the vehicle, as shown in the following figure:

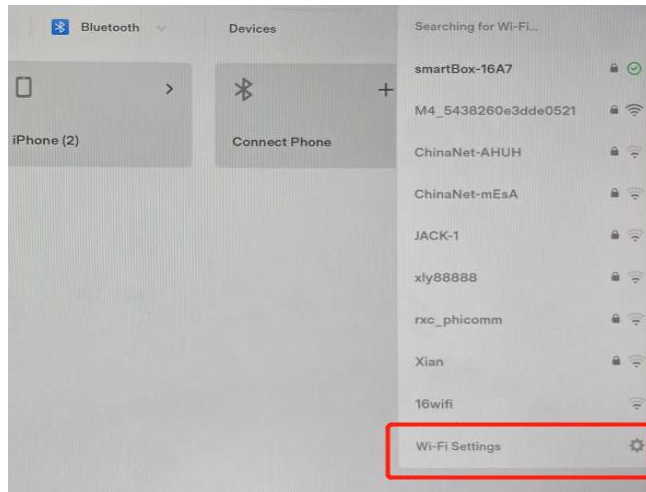

- 21 . Select: [SmartBox...] setting, check [Keep connected during driving], ※ This step is very important, please do not ignore, as shown in the figure below

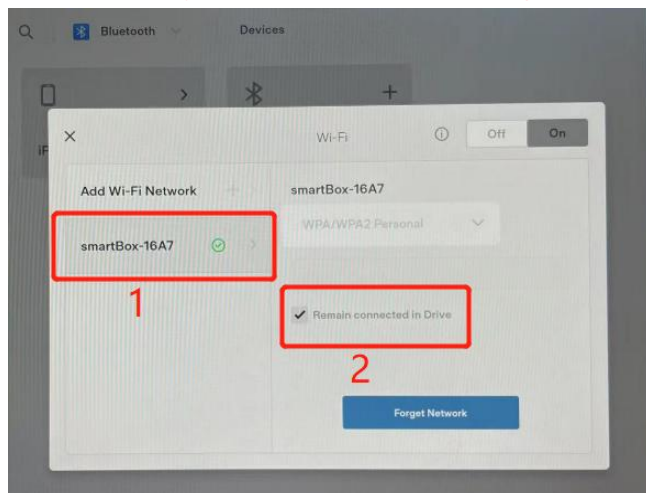

- 22 . The wireless CarPlay connection was successfully [completed].

**[Q & A] Question and Answer:**

**Q:** Can't find the box network or cannot connect to the box's Wi-Fi hotspot

**A:** Press and hold the left and right buttons of the steering wheel down for 6~8 seconds, and the vehicle screen will enter the restart state. And then try to connect again.

**Q:** the car speaker has no sound while using Carplay (1)

**A:** Please check iPhone is disconnected from the Bluetooth of the car or not

**Q:** Carplay has no sound (2)

**A:** When the original car's voice goes to Carplay, please click the Bluetooth icon on the car screen to switch the sound source

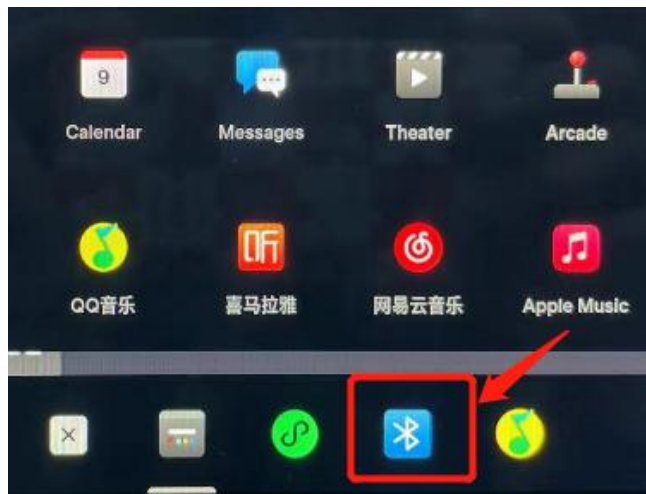

**Product parameters :**

size: 90X63X11mm	Power interface: Type-C	working voltage: 5V
Working system: LINUX	chip: MFI authentication chip	Applicable model: Tesla