

Installation Guide

Picture 1

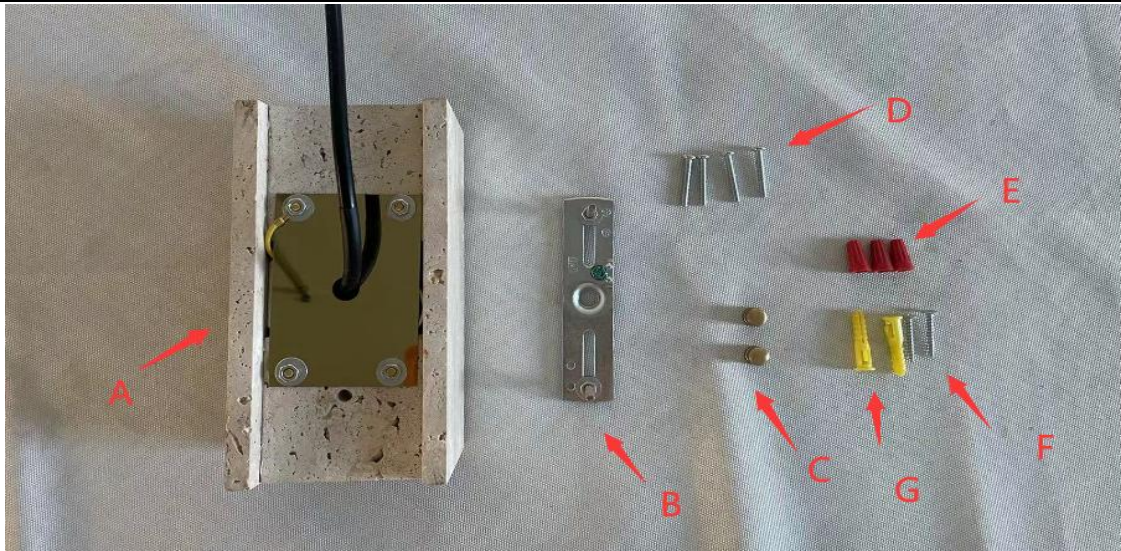

Check accessories: B, C is pre-installed on A, F :4*25mm, D:4*25mm, installation time: 30min, number of installers: 1, installation difficulty: 1

Picture 2



Step 1: Use rubber plug G and self-tapping screw F to fix the plate

Picture 3

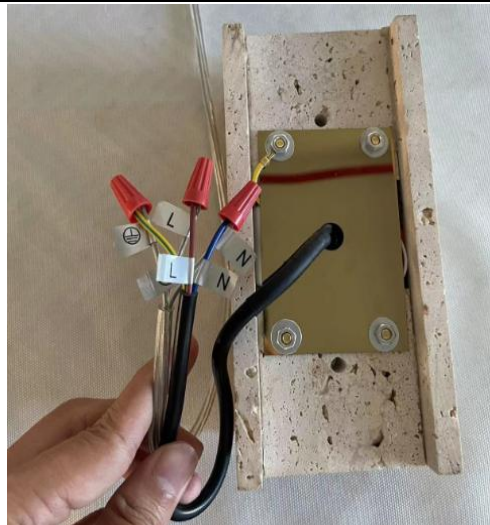

Step 2: As shown in the picture, the pair should be connected to the zero fire ground wire and insulated with wire cap E

Picture 4



Step 3: Fix lamp body A with C

Picture 5



Complete installation